



DryLin® W | Single Rail | Square

4 Dimensions □: 6, 10, 16, 20 mm



Rail
Bearing block

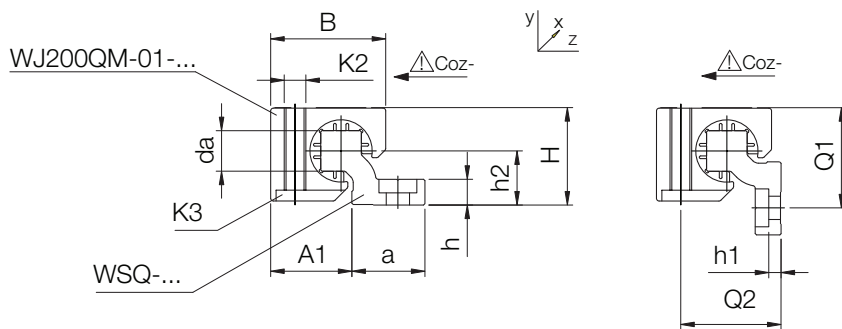
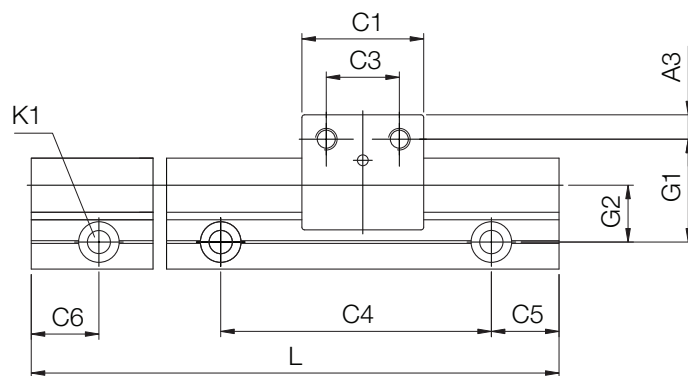

DryLin® W guide rails – Square

Part No.	Weight [kg/m]	H ± 0,07 [mm]	da -0,1 [mm]	L Max. [mm]	a -0,3 [mm]	h	h1	h2	G1	G2	A1	Q1	Q2
WSQ-06	0,23	14	5	3000	14	4	4*	7,5	18	10,5	13,5	17	15
WSQ-10	0,54	20	7,5	4000	25	5,5	5,5*	11	27	17	18,5	26	21
WSQ-16	0,94	27	11,5	4000	27	7,5	3,5	14	33	19	25	32	28
WSQ-20	1,41	36	15	4000	27	9,5	4,5	20	38	21	30	37	37

Part No.	C4	C5 Min.	C5 Max.	C6 Min.	C6 Max.	K1 for screw DIN 912	ly [mm ⁴]	lz [mm ⁴]	Wby [mm ³]	Wbz [mm ³]
WSQ-06	60	20	49,5	20	49,5	M4*	2200	640	220	100
WSQ-10	120	20	79,5	20	79,5	M6*	16100	3300	950	350
WSQ-16	120	20	79,5	20	79,5	M8	33000	10800	1700	910
WSQ-20	120	20	79,5	20	79,5	M8	56500	34000	2600	2100

Standard bore pattern symmetrical: C5 = C6; please order C5 ≠ C6 with drawing

* Through bore

DryLin® W housing bearings – Square

Part No.	Floating bearing play	Floating bearing direction	Weight [g]	B [mm]	C1 [mm]	C3 [mm]	A3 [mm]	K2 [mm]	K3 [mm]	Static load capacity		
										Coy [N]	Coz+ [N]	Coz- [N]
WJ200QM-01-06	-	-	16	18	19	10	4,5	M4	M3	420	420	140
WJ200QM-01-06 LLZ	± 0,5	z	16	18	19	10	4,5	M4	M3	420	420	140
WJ200QM-01-06 LLY	± 0,5	y	16	18	19	10	4,5	M4	M3	420	420	140
WJ200QM-01-10**	-	-	41	26	29	16	6,5	M6	M5	1200	1200	250
WJ200QM-01-10 LLZ	± 0,7	z	41	26	29	16	6,5	M6	M5	1200	1200	250
WJ200QM-01-10 LLY	± 0,7	y	41	26	29	16	6,5	M6	M5	1200	1200	250
WJ200QM-01-16	-	-	100	34,5	36	18	9	M8	M6	2100	2100	400
WJ200QM-01-16 LLZ	± 1,0	z	100	34,5	36	18	9	M8	M6	2100	2100	400
WJ200QM-01-16 LLY	± 1,0	y	100	34,5	36	18	9	M8	M6	2100	2100	400
WJ200QM-01-20**	-	-	190	42,5	45	27	9	M8	M6	3200	3200	500
WJ200QM-01-20 LLZ	± 1,0	z	190	42,5	45	27	9	M8	M6	3200	3200	500
WJ200QM-01-20 LLY	± 1,0	y	190	42,5	45	27	9	M8	M6	3200	3200	500

** Also available as stainless steel version. More on ► Page 63.10

mm

DryLin® W

Phone +49 - 22 03 - 96 49-145

Fax +49 - 22 03 - 96 49-334

igus® GmbH

51147 Cologne

Internet www.igus.de

E-mail info@igus.de