

## Steel guide trough - very stable and rugged for heavy duty applications

If the igus® installation sets are used, the guide troughs are particularly easy to assemble. All the steel guide troughs are constructed according to the same basic principle. On the following pages, you will find information about dimensions, weights and accessories according to the trough size. You will find all necessary design data to stipulate the assembly width on. All sizes use a common C-profile on which the guide parts are assembled. The assembly brackets used vary in height only.

- Easy assembly with installation set
- Big range, two piece design, adjustable to E-Chain® width
- Available in galvanized steel and stainless steel
- Glide bar made of PE

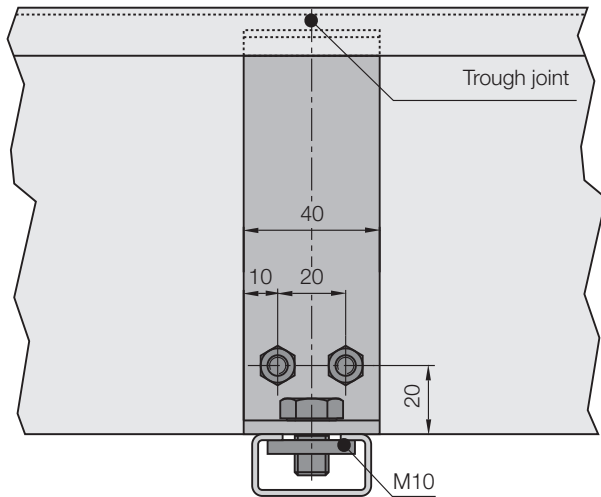

Side view of trough joint. All the dimensions, apart from the height, apply to all sizes

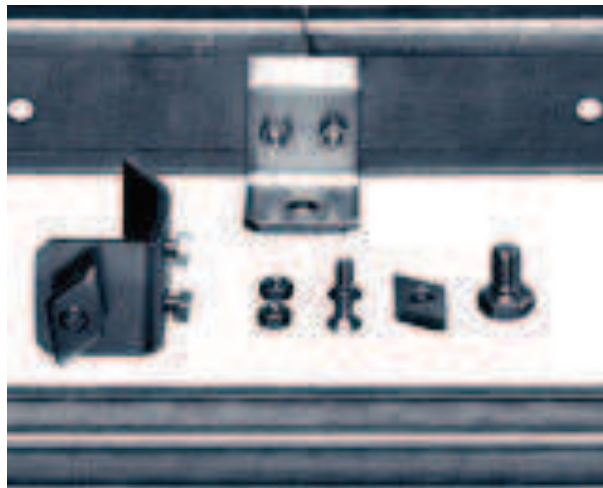

Installation set for joint and attachment surface connections secure connection without misalignment and without welding

### C-profile drilling pattern

Normally galvanized version - Part No. 92.52. XX / Stainless steel version - Part No. 92.52. XX.E  
Tolerance of c-profile lengths -5 mm possible



For the following  
E-Chains®/E-Tubes:

**System E2 Series**

● 2500

● 255

**System E6 Series**

● E6.29/R6.29

**E2 medium classic**

● 250 classic



**Fixed end module**

Quick installation of the mounting brackets due to the prepared bores

► page 9.62

$B_a$  = Outer E-Chain® width

$B_i$  = Inner E-Chain® width

$h_a$  = E-Chain® outer height

$H_{Ri}$  = Inner trough height

$H_{Ra}$  = Outer trough height

$B_{Ri}$  = Inner trough width ►  
depends on dim.  $B_a$

$B_{Ra}$  = Outer trough width

$n_{Mon}$  = Number of installation  
sets (left/right)

$n_{Ri}$  = Number of trough  
sets (left/right)

!  $H_{Ri} \geq 2 \cdot h_a$

!  $B_{Ri} \geq B_a + 5$

● = Guide trough

● = Glide bar

● = Installation set

● = C-profile

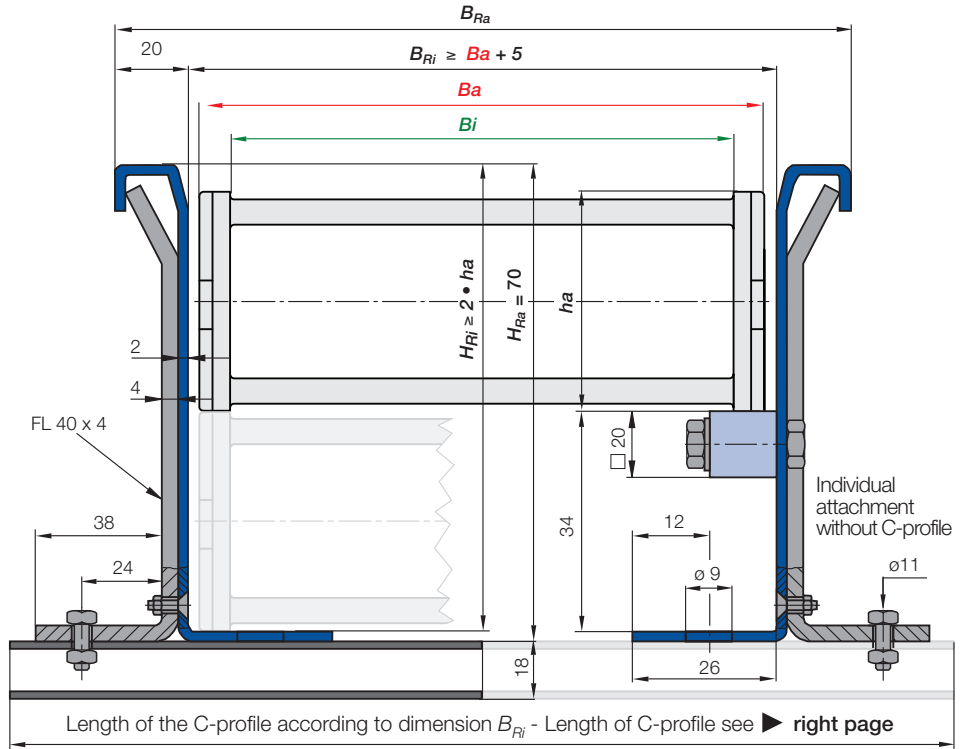

**Steel Guide Trough components - Sets and single parts**

**Complete guide trough sets - description**

Complete guide trough sets - description	Part No.	Weight	kg
Set of 2 trough side parts <b>without</b> glide bars, 2 m section	92.30	≈ 7,60 kg	
Set of 2 trough side parts <b>with</b> glide bars, 2 m section	92.31	≈ 9,60 kg	
1 Installation set with C-profile	92.50. <input type="text"/>		
1 Installation set without C-profile	92.50	≈ 0,34 kg	

**Single parts - description**

1 glide bar, individual, each 2 m	92.01	≈ 0,75 kg	
1 glide bar, individual, each 2 m + 11 screw sets	92.20	≈ 0,98 kg	
11 screw sets for 2 m sections	92.21	≈ 0,23 kg	
1 Clamping bracket, individual	92.51	≈ 0,12 kg	
1 Countersunk-head screw M6 x 14, individual	92.53		
1 Hexagon nut M6, individual	92.54		
1 Hexagon-head screw M10 x 16, individual	92.55		
1 Glide nut M10, individual	92.56		
1 C-profile, individual	92.52. <input type="text"/>	≈ 0,90 kg/m	

Supplement Part No. with the indicated C-profile-length-index. **Example:** 92.50.175

C-profile-length-index for your chosen trough inner width  $B_{Ri}$  ► right table

Trough side parts also available in stainless steel. Please add index "E" to the Part No. 92.30.E

**Principle sketch: Number of installation sets which have to be installed**

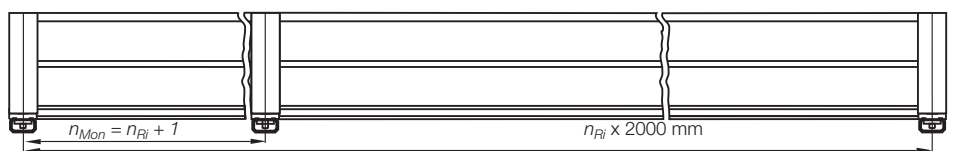

Calculation - travel  
center mounted

Half travel length, rounded down  
to full 2 m sections = X m guide  
trough length without glide bars  
+ X m guide trough length with  
glide bars + installation sets  
(number of trough pieces + 1)



**Order example: Length of travel 30 m -  
Center mounted for Series 2500.05.200.0 with  $B_{Ri} = 78$**

Guide trough-set of 2 trough side parts, <b>without</b> glide bars:	
<b>16 m Guide trough = 8 x 2 m sections (without glide bars)</b>	<b>Part No. 92.30</b>
Guide trough-set of 2 trough side parts, <b>with</b> assembled glide bars:	
<b>16 m Guide trough = 8 x 2 m sections (with glide bars)</b>	<b>Part No. 92.31</b>
Installation sets complete (Guide trough-sets + 1)	
<b>17 Installation sets (with C-profile)</b>	<b>Part No. 92.50.200</b>

## Part No. Installation set: Steel Guide Trough with C-profile (in dependance of the width)

### 2500

2500.03.200.0

	$B_{Ri}$	Part No.
	[mm]	Installation set
.02	46	*
.03	59	92.50.175
.05	78	92.50.200
.07	98	92.50.225
.09	110	92.50.225
.10	124	92.50.250
.12	146	92.50.275

### 255

255.03.200.0

	$B_{Ri}$	Part No.
	[mm]	Installation set
.03	59	92.50.175
.05	78	92.50.200
.07	98	92.50.225
.10	124	92.50.250

### E6.29/R6.29

E6.29.040.100.0

	$B_{Ri}$	Part No.
	[mm]	Installation set
.030	51	*
.040	61	92.50.175
.050	71	92.50.200
.060	81	92.50.200
.070	91	92.50.200
.080	101	92.50.225
.090	111	92.50.225
.100	121	92.50.250
.110	131	92.50.250
.120	141	92.50.250

\*upon request



For the following  
E-Chains®/E-Tubes:

System E2 Series

● 2700

System E2 Tubes Series

● R58

E2 medium classic

● 27 classic



**Fixed end module**

Quick installation of the mounting brackets due to the prepared bores

► page 9.62

$B_a$  = Outer E-Chain® width

$B_i$  = Inner E-Chain® width

$h_a$  = E-Chain® outer height

$H_{Ri}$  = Inner trough height

$H_{Ra}$  = Outer trough height

$B_{Ri}$  = Inner trough width ► depends on dim.  $B_a$

$B_{Ra}$  = Outer trough width

$n_{Mon}$  = Number of installation sets (left/right)

$n_{Ri}$  = Number of trough sets (left/right)

!  $H_{Ri} \geq 2 \cdot h_a$   
■  $B_{Ri} \geq B_a + 5$

● = Guide trough

● = Glide bar

● = Installation set

● = C-profile

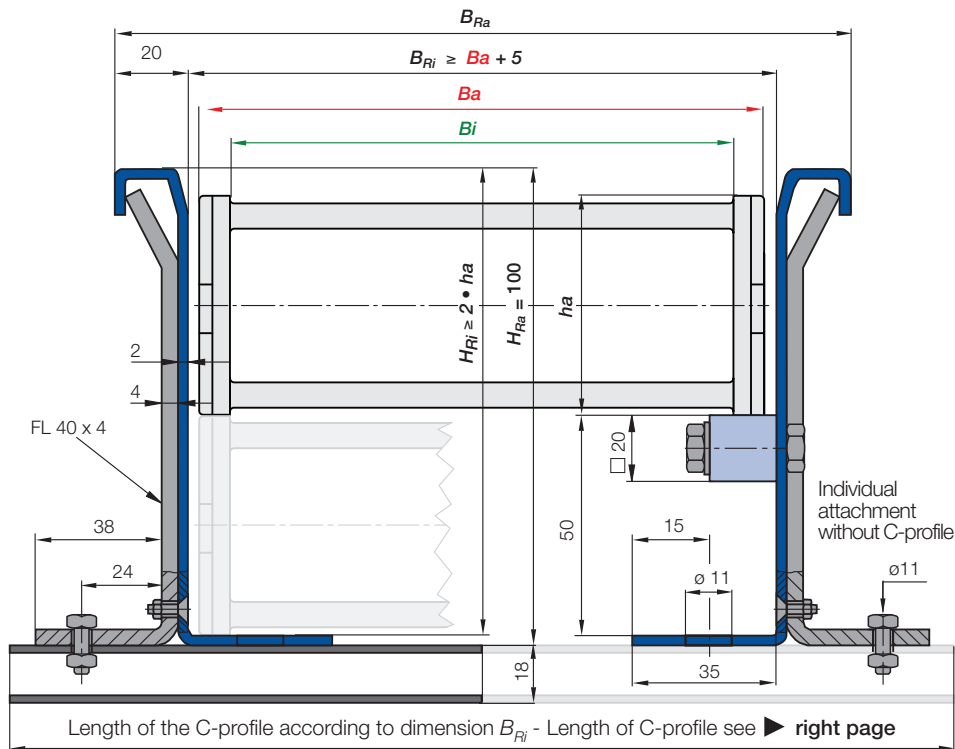

**Steel Guide Trough components - Sets and single parts**

Complete guide trough sets - description	Part No.	Weight	kg
Set of 2 trough side parts <b>without</b> glide bars, 2 m section	95.30	≈ 10,00 kg	
Set of 2 trough side parts <b>with</b> glide bars, 2 m section	95.31	≈ 12,00 kg	
1 Installation set with C-profile	95.50. <input type="text"/>		
1 Installation set without C-profile	95.50	≈ 0,41 kg	
Single parts - description			
1 glide bar, individual, each 2 m	92.01	≈ 0,75 kg	
1 glide bar, individual, each 2 m + 11 screw sets	92.20	≈ 0,98 kg	
11 screw sets for 2 m sections	92.21	≈ 0,23 kg	
1 Clamping bracket, individual	95.51	≈ 0,16 kg	
1 Countersunk-head screw M6 x 14, individual	92.53		
1 Hexagon nut M6, individual	92.54		
1 Hexagon-head screw M10 x 16, individual	92.55		
1 Glide nut M10, individual	92.56		
1 C-profile, individual	92.52. <input type="text"/>	≈ 0,90 kg/m	

Supplement Part No. with the indicated C-profile-length-index. Example: 95.50. 200

C-profile-length-index for your chosen trough inner width  $B_{Ri}$  ► right table

Trough side parts also available in stainless steel. Please add index "E" to the Part No. 95.30.E

**Principle sketch: Number of installation sets which have to be installed**

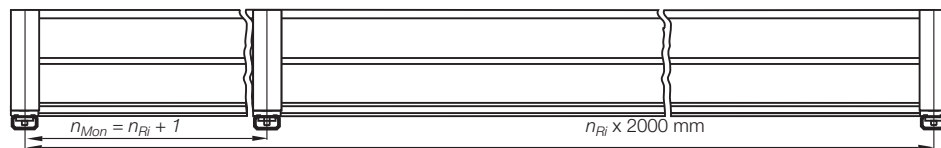

Calculation - travel center mounted

Half travel length, rounded down to full 2 m sections = X m guide trough length without glide bars + X m guide trough length with glide bars + installation sets (number of trough pieces + 1)



**Order example: Length of travel 30 m - Center mounted for Series 2700.05.200.0 with  $B_{Ri} = 71$**

Guide trough-set of 2 trough side parts, <b>without</b> glide bars:	
<b>16 m Guide trough = 8 x 2 m sections (without glide bars)</b>	<b>Part No. 95.30</b>
Guide trough-set of 2 trough side parts, <b>with</b> assembled glide bars:	
<b>16 m Guide trough = 8 x 2 m sections (with glide bars)</b>	<b>Part No. 95.31</b>
Installation sets complete (Guide trough-sets + 1)	
<b>17 Installation sets (with C-profile)</b>	<b>Part No. 95.50. <input type="text"/>200</b>

## Part No. Installation set: Steel Guide Trough with C-profile (in dependance of the width)

### 2700

2700.05.200.0

	$B_{Ri}$	Part No.
	[mm]	Installation set
.05	71	95.50.200
.06	86	95.50.200
.07	96	95.50.225
.09	111	95.50.225
.10	121	95.50.250
.12	146	95.50.275
.15	171	95.50.300
.17	199	95.50.325

### R58

58.050.200.0

	$B_{Ri}$	Part No.
	[mm]	Installation set
.050	71	95.50.200
.075	96	95.50.225
.100	121	95.50.250
.125	146	95.50.275
.150	171	95.50.300
.175	196	95.50.325
.200	221	95.50.350

! The inner width of the guide through and the lenght of the C-Profile of the assembly kit can differ according to the bracket you choose. Please call us!



For the following  
E-Chains®/E-Tubes:

System E4 Series

● E4.28/R4.28

● 220/R760

● E6.35



Fixed end module

Quick installation of the mounting brackets due to the prepared bores

► page 9.62

$B_a$  = Outer E-Chain® width

$B_i$  = Inner E-Chain® width

$h_a$  = E-Chain® outer height

$H_{Ri}$  = Inner trough height

$H_{Ra}$  = Outer trough height

$B_{Ri}$  = Inner trough width ►  
depends on dim.  $B_a$

$B_{Ra}$  = Outer trough width

$n_{Mon}$  = Number of installation  
sets (left/right)

$n_{Ri}$  = Number of trough  
sets (left/right)

**$H_{Ri} \geq 2 \cdot h_a$**

**$B_{Ri} \geq B_a + 5$**

● = Guide trough

● = Glide bar

● = Installation set

● = C-profile

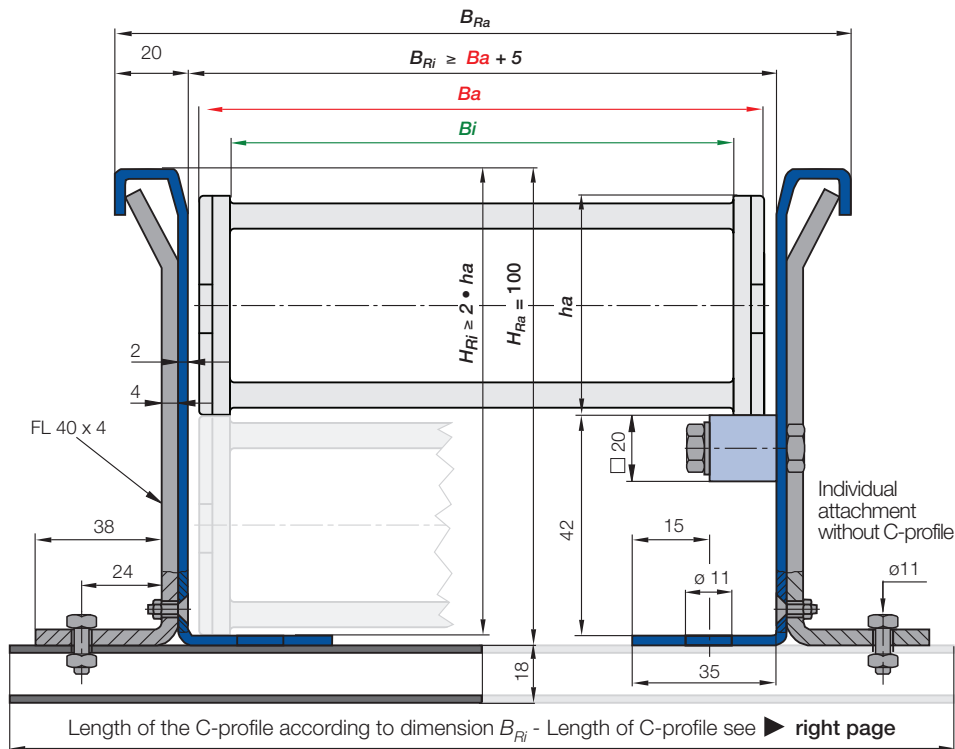

Steel Guide Trough components - Sets and single parts

Complete guide trough sets - description	Part No.	Weight	kg
Set of 2 trough side parts <b>without</b> glide bars, 2 m section	99.30	≈ 10,00 kg	
Set of 2 trough side parts <b>with</b> glide bars, 2 m section	99.31	≈ 12,00 kg	
1 Installation set with C-profile	95.50. <input type="text"/>		
1 Installation set without C-profile	95.50.	≈ 0,41 kg	
Single parts - description			
1 glide bar, individual, each 2 m	92.01	≈ 0,75kg	
1 glide bar, individual, each 2 m + 11 screw sets	92.20	≈ 0,98 kg	
11 screw sets for 2 m sections	92.21	≈ 0,23 kg	
1 Clamping bracket, individual	95.51	≈ 0,16 kg	
1 Countersunk-head screw M6 x 14, individual	92.53		
1 Hexagon nut M6, individual	92.54		
1 Hexagon-head screw M10 x 16, individual	92.55		
1 Glide nut M10, individual	92.56		
1 C-profile, individual	92.52. <input type="text"/>	≈ 0,90 kg/m	

Supplement Part No. with the indicated C-profile-length-index. Example: 95.50.

C-profile-length-index for your chosen trough inner width  $B_{Ri}$  ► right table

Trough side parts also available in stainless steel. Please add index "E" to the Part No. 99.30.E

Principle sketch: Number of installation sets which have to be installed

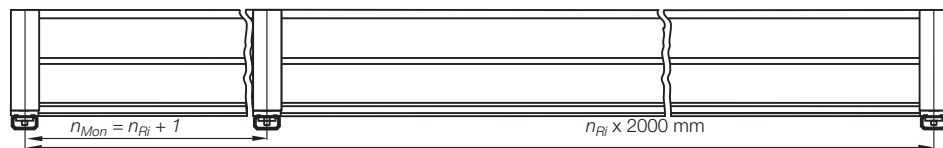

Calculation - travel  
center mounted

Half travel length, rounded down to full 2 m sections = X m guide trough length without glide bars + X m guide trough length with glide bars + installation sets (number of trough pieces + 1)



Order example: Length of travel 30 m -  
Center mounted for Series E4.28.050.200.0 with  $B_{Ri} = 75$

Guide trough-set of 2 trough side parts, <b>without</b> glide bars:	
16 m Guide trough = 8 x 2 m sections (without glide bars)	Part No. 99.30
Guide trough-set of 2 trough side parts, <b>with</b> assembled glide bars:	
16 m Guide trough = 8 x 2 m sections (with glide bars)	Part No. 99.31
Installation sets complete (Guide trough-sets + 1)	
17 Installation sets (with C-profile)	Part No. 95.50. <input type="text"/>

## Part No. Installation set: Steel Guide Trough with C-profile (in dependance of the width)

### E4.28/R4.28

E4.28.040.200.0

	$B_{Ri}$	Part No.
	[mm]	Installation set
.040	65	*
.050	75	95.50.200
.062	87	95.50.200
.070	95	95.50.200
.075	100	95.50.225
.087	112	95.50.225
.100	125	95.50.250
.125	150	95.50.275
.150	175	95.50.300
.175	200	95.50.325
.200	225	95.50.350
.225	250	95.50.375
.250	275	95.50.400
.275	300	95.50.425
.300	325	95.50.450

### 220/R760

220.040.200.0

	$B_{Ri}$	Part No.
	[mm]	Installation set
.040	65	*
.050	75	95.50.200
.062	87	95.50.200
.070	95	95.50.200
.075	100	95.50.225
.087	112	95.50.225
.100	125	95.50.250
.125	150	95.50.275
.150	175	95.50.300
.175	200	95.50.325
.200	225	95.50.350
.225	250	95.50.375
.250	275	95.50.400
.275	300	95.50.425
.300	325	95.50.450

### E6.35

E6.35.100.055.0

	$B_{Ri}$	Part No.
	[mm]	Installation set
.030	55	*
.040	65	*
.050	75	95.50.200
.060	85	95.50.200
.070	95	95.50.200
.080	105	95.50.225
.090	115	95.50.225
.100	125	95.50.250
.110	135	95.50.250
.120	145	95.50.250

\*upon request











For the following  
E-Chains®/E-Tubes:

**System E2 Series**

- 3500

**System E2 Tubes Series**

- R68

**System E4 Series**

- E4.42/H4.42/R4.42

- 380/390/R780

- 3838/3938/R7838

**System E6 Series**

- E6.52/R6.52

**E2 medium classic**

- 350 classic



**Fixed end module**

Quick installation of the mounting brackets due to the prepared bores

► page 9.62

$B_a$  = Outer E-Chain® width

$B_i$  = Inner E-Chain® width

$h_a$  = E-Chain® outer height

$H_{Ri}$  = Inner trough height

$H_{Ra}$  = Outer trough height

$B_{Ri}$  = Inner trough width ►  
depends on dim.  $B_a$

$B_{Ra}$  = Outer trough width

$n_{Mon}$  = Number of installation sets (left/right)

$n_{Ri}$  = Number of trough sets (left/right)

**$H_{Ri} \geq 2 \cdot h_a$**

**$B_{Ri} \geq B_a + 5$**

● = Guide trough

○ = Glide bar

■ = Installation set

● = C-profile

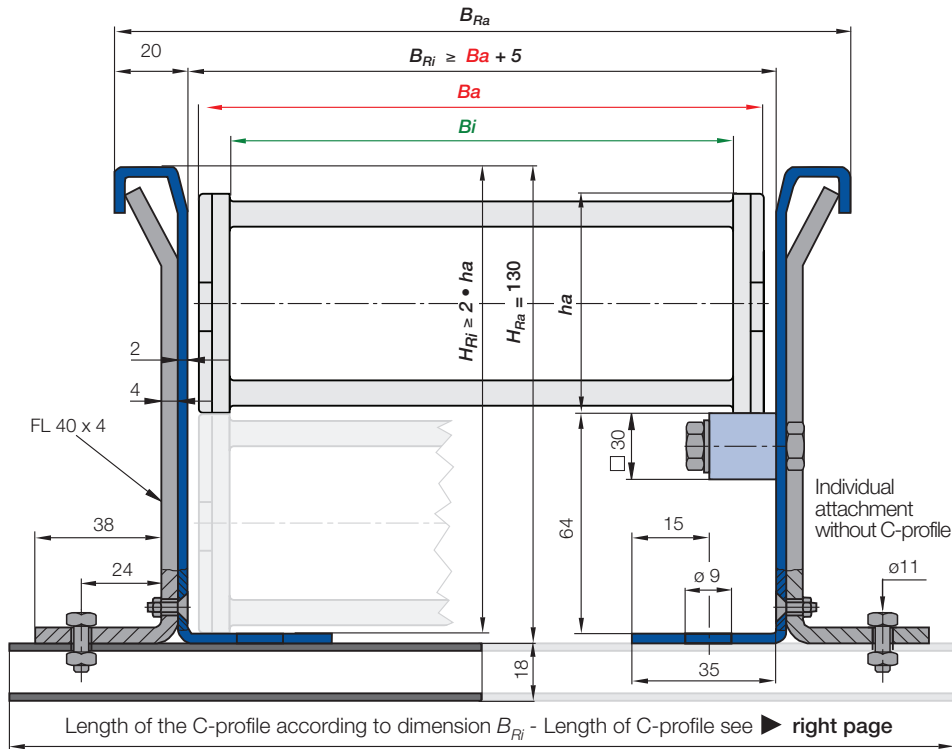

**Steel Guide Trough components - Sets and single parts**

Complete guide trough sets - description	Part No.	Weight	kg
Set of 2 trough side parts <b>without</b> glide bars, 2 m section	93.30	≈ 11,80 kg	
Set of 2 trough side parts <b>with</b> glide bars, 2 m section	93.31	≈ 16,20 kg	
1 Installation set with C-profile	93.50. <input type="text"/>		
1 Installation set without C-profile	93.50	≈ 0,49 kg	
Single parts - description			
1 glide bar, individual, each 2 m	93.01	≈ 1,68 kg	
1 glide bar, individual, each 2 m + 11 screw sets	93.20	≈ 2,22 kg	
11 screw sets for 2 m sections	93.21	≈ 0,54 kg	
1 Clamping bracket, individual	93.51	≈ 0,20 kg	
1 Countersunk-head screw M6 x 14, individual	92.53		
1 Hexagon nut M6, individual	92.54		
1 Hexagon-head screw M10 x 16, individual	92.55		
1 Glide nut M10, individual	92.56		
1 C-profile, individual	92.52. <input type="text"/>	≈ 0,90 kg/m	

Supplement Part No. with the indicated C-profile-length-index. **Example: 93.50.225**

C-profile-length-index for your chosen trough inner width  $B_{Ri}$  ► right table

Trough side parts also available in stainless steel. Please add index "E" to the Part No. 93.30.E

**Principle sketch: Number of installation sets which have to be installed**

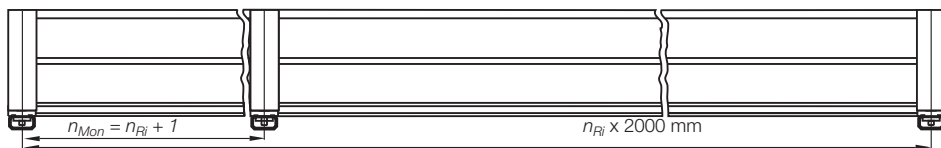

Calculation - travel  
center mounted

Half travel length, rounded down to full 2 m sections = X m guide trough length without glide bars + X m guide trough length with glide bars + installation sets (number of trough pieces + 1)



**Order example: Length of travel 30 m - Center mounted for Series 3500.075.200.0 with  $B_{Ri} = 100$**

Guide trough-set of 2 trough side parts, <b>without</b> glide bars:	
<b>16 m Guide trough = 8 x 2 m sections (without glide bars)</b>	<b>Part No. 93.30</b>
Guide trough-set of 2 trough side parts, <b>with</b> assembled glide bars:	
<b>16 m Guide trough = 8 x 2 m sections (with glide bars)</b>	<b>Part No. 93.31</b>
Installation sets complete (Guide trough-sets + 1)	
<b>17 Installation sets (with C-profile)</b>	<b>Part No. 93.50.225</b>

## Part No. Installation set: Steel Guide Trough with C-profile (in dependance of the width)

### 3500

3500.050.200.0

$B_{Ri}$ [mm]	Part No. Installation set
.050 75	93.50.200
.075 100	93.50.225
.100 125	93.50.250
.115 140	93.50.250
.125 150	93.50.275
.150 175	93.50.300
.175 200	93.50.325
.200 225	93.50.350
.225 250	93.50.375
.250 275	93.50.400

### R68

68.050.200.0

$B_{Ri}$ [mm]	Part No. Installation set
.050 73	93.50.200
.075 98	93.50.225
.100 123	93.50.250
.115 138	93.50.250
.125 148	93.50.275
.150 173	93.50.300
.175 198	93.50.325
.200 223	93.50.350
.225 248	93.50.375
.250 273	93.50.400

### E4.42/H4.42/R4.42

E4.42.07.200.0

$B_{Ri}$ [mm]	Part No. Installation set
.05 81	93.50.200
.06 99	93.50.225
.07 106	93.50.225
.087 119	93.50.250
.10 131	93.50.250
.11 139	93.50.250
.112 144	93.50.275
.12 156	93.50.275
.137 169	93.50.300
.15 181	93.50.300
.162 194	93.50.325
.17 199	93.50.325
.18 206	93.50.325
.187 219	93.50.350
.20 231	93.50.350
.212 244	93.50.375
.23 256	93.50.375
.237 269	93.50.400
.25 281	93.50.400
.262 294	93.50.425
.28 306	93.50.425
.29 319	93.50.450
.30 331	93.50.450
.312 344	93.50.475
.325 356	93.50.475
.337 369	93.50.500
.350 381	93.50.500
.362 394	93.50.525
.375 407	93.50.525
.387 419	93.50.550
.400 431	93.50.550

### 380/390/R780

390.07.200.0

$B_{Ri}$ [mm]	Part No. Installation set
.05 81	93.50.200
.06 99	93.50.225
.07 106	93.50.225
.087 119	93.50.250
.10 131	93.50.250
.11 139	93.50.250
.112 144	93.50.275
.12 156	93.50.275
.137 169	93.50.300
.15 181	93.50.300
.162 194	93.50.325
.17 199	93.50.325
.18 206	93.50.325
.187 219	93.50.350
.20 231	93.50.350
.212 244	93.50.375
.23 256	93.50.375
.237 269	93.50.400
.25 281	93.50.400
.262 294	93.50.425
.28 306	93.50.425
.29 319	93.50.450
.30 331	93.50.450
.312 344	93.50.475
.325 356	93.50.475
.337 369	93.50.500
.350 381	93.50.500
.362 394	93.50.525
.375 407	93.50.525
.387 419	93.50.550
.400 431	93.50.550

### 3838/3938/R7838

3838.05.200.0

$B_{Ri}$ [mm]	Part No. Installation set
.05 82	93.50.200
.06 100	93.50.225
.07 107	93.50.225
.087 120	93.50.250
.10 132	93.50.250
.11 140	93.50.250
.112 145	93.50.275
.12 157	93.50.275
.137 170	93.50.300
.15 182	93.50.300
.162 195	93.50.325
.17 200	93.50.325
.18 207	93.50.325
.187 220	93.50.350
.20 232	93.50.350
.212 245	93.50.375
.23 257	93.50.375
.237 270	93.50.400
.25 282	93.50.400
.262 295	93.50.425
.28 307	93.50.425
.29 320	93.50.450
.30 332	93.50.450
.312 345	93.50.475
.325 357	93.50.475
.337 370	93.50.500
.350 382	93.50.500
.362 395	93.50.525
.375 407	93.50.525
.387 420	93.50.550
.400 432	93.50.550

### E6.52/R6.52

E6.52.040.200.0

$B_{Ri}$ [mm]	Part No. Installation set
.040 69	*
.050 79	93.50.200
.062 91	93.50.200
.070 99	93.50.225
.075 104	93.50.225
.087 116	93.50.225
.100 129	93.50.250
.125 154	93.50.275
.150 179	93.50.300
.175 204	93.50.325
.200 229	93.50.350
.225 254	93.50.375
.250 279	93.50.400
.275 304	93.50.425
.300 329	93.50.450

\*upon request



For the following  
E-Chains®/E-Tubes:

**System E4 Series**

- E4.56/H4.56/R4.56
- 400/410/R880
- 4040/4140/R8840
- 4040HD/R8840HD
- 14040/14140/R18840
- 14240/14340

● E6.62

**System E6 Series**



**Fixed end module**

Quick installation of the mounting brackets due to the prepared bores

▶ page 9.62

$B_a$  = Outer E-Chain® width

$B_i$  = Inner E-Chain® width

$h_a$  = E-Chain® outer height

$H_{Ri}$  = Inner trough height

$H_{Ra}$  = Outer trough height

$B_{Ri}$  = Inner trough width ▶ depends on dim.  $B_a$

$B_{Ra}$  = Outer trough width

$n_{Mon}$  = Number of installation sets (left/right)

$n_{Ri}$  = Number of trough sets (left/right)

**$H_{Ri} \geq 2 \cdot h_a$**

**$B_{Ri} \geq B_a + 5$**

● = Guide trough

● = Glide bar

● = Installation set

● = C-profile

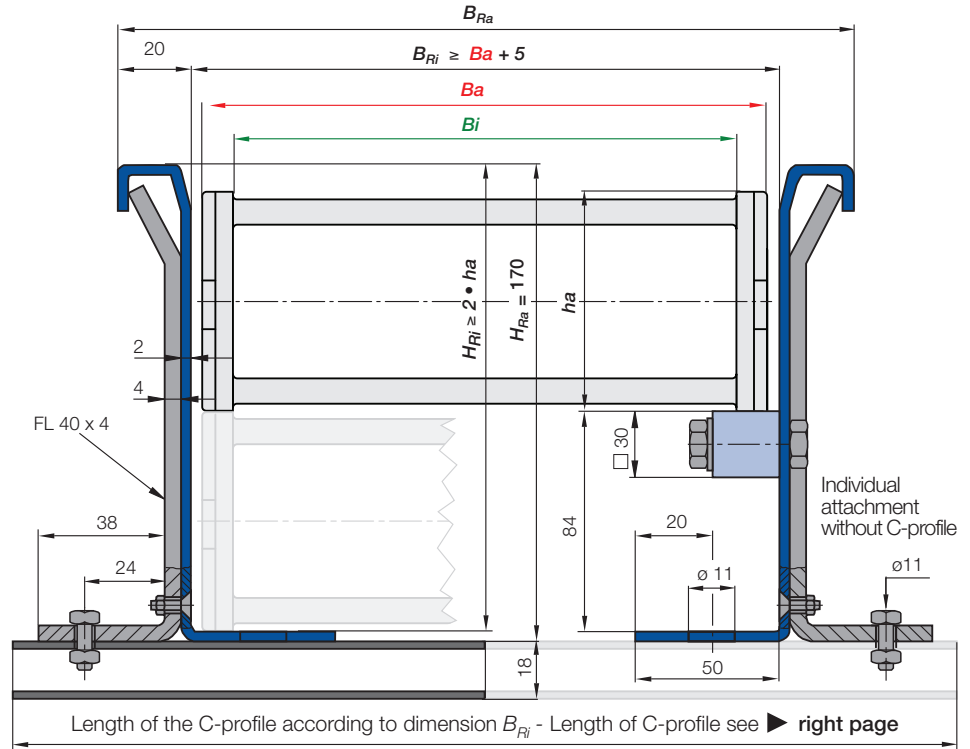

**Steel Guide Trough components - Sets and single parts**

Complete guide trough sets - description	Part No.	Weight	kg
Set of 2 trough side parts <b>without</b> glide bars, 2 m section	<b>94.30</b>	≈ 14,70 kg	
Set of 2 trough side parts <b>with</b> glide bars, 2 m section	<b>94.31</b>	≈ 19,00 kg	
1 Installation set with C-profile	<b>94.50.</b> <input type="text"/>		
1 Installation set without C-profile	<b>94.50</b>	≈ 0,58 kg	
Single parts - description			
1 glide bar, individual, each 2 m	<b>93.01</b>	≈ 1,68 kg	
1 glide bar, individual, each 2 m + 11 screw sets	<b>93.20</b>	≈ 2,22 kg	
11 screw sets for 2 m sections	<b>93.21</b>	≈ 0,54 kg	
1 Clamping bracket, individual	<b>94.51</b>	≈ 0,25 kg	
1 Countersunk-head screw M6 x 14, individual	<b>92.53</b>		
1 Hexagon nut M6, individual	<b>92.54</b>		
1 Hexagon-head screw M10 x 16, individual	<b>92.55</b>		
1 Glide nut M10, individual	<b>92.56</b>		
1 C-profile, individual	<b>92.52.</b> <input type="text"/>	≈ 0,90 kg/m	

Supplement Part No. with the indicated C-profile-length-index. **Example:** 94.50.225

C-profile-length-index for your chosen trough inner width  $B_{Ri}$  ▶ right table

Trough side parts also available in stainless steel. Please add index "E" to the Part No. 94.30.E

**Principle sketch: Number of installation sets which have to be installed**

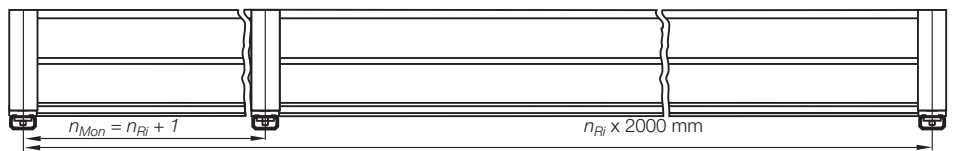

Calculation - travel center mounted

Half travel length, rounded down to full 2 m sections = **X m guide trough length without glide bars** + **X m guide trough length with glide bars + installation sets** (number of trough pieces + 1)



**Order example: Length of travel 30 m - Center mounted for Series E4.56.06.200.0 with  $B_{Ri} = 104$**

Guide trough-set of 2 trough side parts, **without** glide bars:

**16 m Guide trough = 8 x 2 m sections (without glide bars)** **Part No. 94.30**

Guide trough-set of 2 trough side parts, **with** assembled glide bars:

**16 m Guide trough = 8 x 2 m sections (with glide bars)** **Part No. 94.31**

Installation sets complete (Guide trough-sets + 1)

**17 Installation sets (with C-profile)** **Part No. 94.50.225**

## Part No. Installation set: Steel Guide Trough with C-profile (in dependance of the width)

E4.56/H4.56/R4.56		400/410/R880		4040/4140/R8840		4040HD/R8840HD		14040/14140/R18840		14240/14340		E6.62		
E4.56.10.200.0		400.10.200.0		4040.05.200.0		4040HD.05.200.0		14040.05.200.0		14240.05.200.0		E6.62.05.200.0		
$B_{Ri}$	Part No.	$B_{Ri}$	Part No.	$B_{Ri}$	Part No.	$B_{Ri}$	Part No.	$B_{Ri}$	Part No.	$B_{Ri}$	Part No.	$B_{Ri}$	Part No.	
[mm]	Installation set	[mm]	Installation set	[mm]	Installation set	[mm]	Installation set	[mm]	Installation set	[mm]	Installation set	[mm]	Installation set	
.05	89	*	.05	89	*	.05	91	*	.05	81	*	.05	81	*
.06	104	94.50.225	.06	104	94.50.225	.06	106	94.50.225	.06	124	94.50.250	.06	96	*
.07	114	94.50.225	.07	114	94.50.225	.07	116	94.50.225	.07	134	94.50.250	.07	106	94.50.225
.10	139	94.50.250	.10	139	94.50.250	.10	141	94.50.250	.10	159	94.50.275	.10	131	94.50.250
.11	152	94.50.275	.11	152	94.50.275	.11	154	94.50.275	.11	171	94.50.300	.11	144	94.50.275
.12	164	94.50.275	.12	164	94.50.275	.12	166	94.50.275	.12	184	94.50.300	.12	156	94.50.275
.13	177	94.50.300	.13	177	94.50.300	.13	179	94.50.300	.13	196	94.50.325	.13	169	94.50.300
.15	189	94.50.300	.15	189	94.50.300	.15	191	94.50.300	.15	209	94.50.325	.15	181	94.50.300
.16	202	94.50.325	.16	202	94.50.325	.16	204	94.50.325	.16	221	94.50.350	.16	194	94.50.325
.17	214	94.50.325	.17	214	94.50.325	.17	216	94.50.325	.17	234	94.50.350	.17	206	94.50.325
.18	227	94.50.350	.18	227	94.50.350	.18	229	94.50.350	.18	246	94.50.375	.18	219	94.50.350
.20	239	94.50.350	.20	239	94.50.350	.20	241	94.50.350	.20	259	94.50.375	.20	231	94.50.350
.21	252	94.50.375	.21	252	94.50.375	.21	254	94.50.375	.21	271	94.50.400	.21	244	94.50.375
.22	264	94.50.375	.22	264	94.50.375	.22	266	94.50.375	.22	284	94.50.400	.22	256	94.50.375
.23	277	94.50.400	.23	277	94.50.400	.23	279	94.50.400	.23	296	94.50.425	.23	269	94.50.400
.25	289	94.50.400	.25	289	94.50.400	.25	291	94.50.400	.25	309	94.50.425	.25	281	94.50.400
.26	302	94.50.425	.26	302	94.50.425	.26	304	94.50.425	.26	321	94.50.450	.26	294	94.50.425
.27	314	94.50.425	.27	314	94.50.425	.27	316	94.50.425	.27	334	94.50.450	.27	306	94.50.425
.28	327	94.50.450	.28	327	94.50.450	.28	329	94.50.450	.28	346	94.50.475	.28	319	94.50.450
.30	339	94.50.450	.30	339	94.50.450	.30	341	94.50.450	.30	359	94.50.475	.30	331	94.50.450
.31	352	94.50.475	.31	352	94.50.475	.31	354	94.50.475	.31	371	94.50.500	.31	344	94.50.475
.32	364	94.50.475	.32	364	94.50.475	.32	366	94.50.475	.32	384	94.50.500	.32	356	94.50.475
.33	377	94.50.500	.33	377	94.50.500	.33	379	94.50.500	.33	396	94.50.525	.33	369	94.50.500
.35	389	94.50.500	.35	389	94.50.500	.35	391	94.50.500	.35	409	94.50.525	.35	381	94.50.500
.36	402	94.50.525	.36	402	94.50.525	.36	404	94.50.525	.36	421	94.50.550	.36	394	94.50.525
.37	414	94.50.525	.37	414	94.50.525	.37	416	94.50.525	.37	434	94.50.550	.37	406	94.50.525
.38	427	94.50.550	.38	427	94.50.550	.38	429	94.50.550	.38	446	94.50.575	.38	419	94.50.550
.40	439	94.50.550	.40	439	94.50.550	.40	441	94.50.550	.40	459	94.50.575	.40	431	94.50.550
.41	452	94.50.575	.41	452	94.50.575	.41	454	94.50.575	.41	471	94.50.600	.41	444	94.50.575
.42	464	94.50.575	.42	464	94.50.575	.42	466	94.50.575	.42	484	94.50.600	.42	456	94.50.575
.43	477	94.50.600	.43	477	94.50.600	.43	479	94.50.600	.43	496	94.50.625	.43	469	94.50.600
.45	489	94.50.600	.45	489	94.50.600	.45	491	94.50.600	.45	509	94.50.625	.45	481	94.50.600
.46	502	94.50.625	.46	502	94.50.625	.46	504	94.50.625	.46	521	94.50.650	.46	494	94.50.625
.47	514	94.50.625	.47	514	94.50.625	.47	516	94.50.625	.47	534	94.50.650	.47	506	94.50.625
.48	527	94.50.650	.48	527	94.50.650	.48	529	94.50.650	.48	546	94.50.675	.48	519	94.50.650
.50	539	94.50.650	.50	539	94.50.650	.50	541	94.50.650	.50	559	94.50.675	.50	531	94.50.650
.51	552	94.50.675	.51	552	94.50.675	.51	554	94.50.675	.51	571	94.50.700	.51	544	94.50.675
.52	564	94.50.675	.52	564	94.50.675	.52	566	94.50.675	.52	584	94.50.700	.52	556	94.50.675
.53	577	94.50.700	.53	577	94.50.700	.53	579	94.50.700	.53	596	94.50.725	.53	569	94.50.700
.55	589	94.50.700	.55	589	94.50.700	.55	591	94.50.700	.55	609	94.50.725	.55	581	94.50.700
.60	639	94.50.750	.60	639	94.50.750	.60	641	94.50.750	.60	659	94.50.775	.60	631	94.50.750

\*upon request



Trough (Part No. 94.30 and 94.31)  
with reinforced mounting angles for  
very rugged and extreme applications

! The inner width of the guide through and the length of the C-Profile of the assembly kit can differ according to the bracket you choose. Please call us!



For the following  
E-Chains®/E-Tubes:

**System E4 Series**

- E4.80/H4.80/R4.80
- 5050/5150/R9850
- 5050HD/R9850HD
- 15050/15150/R19850

**System E6 Series**

- E6.80



**Fixed end module**

Quick installation of the mounting brackets due to the prepared bores

► page 9.62

$B_a$  = Outer E-Chain® width

$B_i$  = Inner E-Chain® width

$h_a$  = E-Chain® outer height

$H_{Ri}$  = Inner trough height

$H_{Ra}$  = Outer trough height

$B_{Ri}$  = Inner trough width ► depends on dim.  $B_a$

$B_{Ra}$  = Outer trough width

$n_{Mon}$  = Number of installation sets (left/right)

$n_{Ri}$  = Number of trough sets (left/right)

**$H_{Ri} \geq 2 \cdot h_a$**

**$B_{Ri} \geq B_a + 5$**

● = Guide trough

● = Glide bar

● = Installation set

● = C-profile

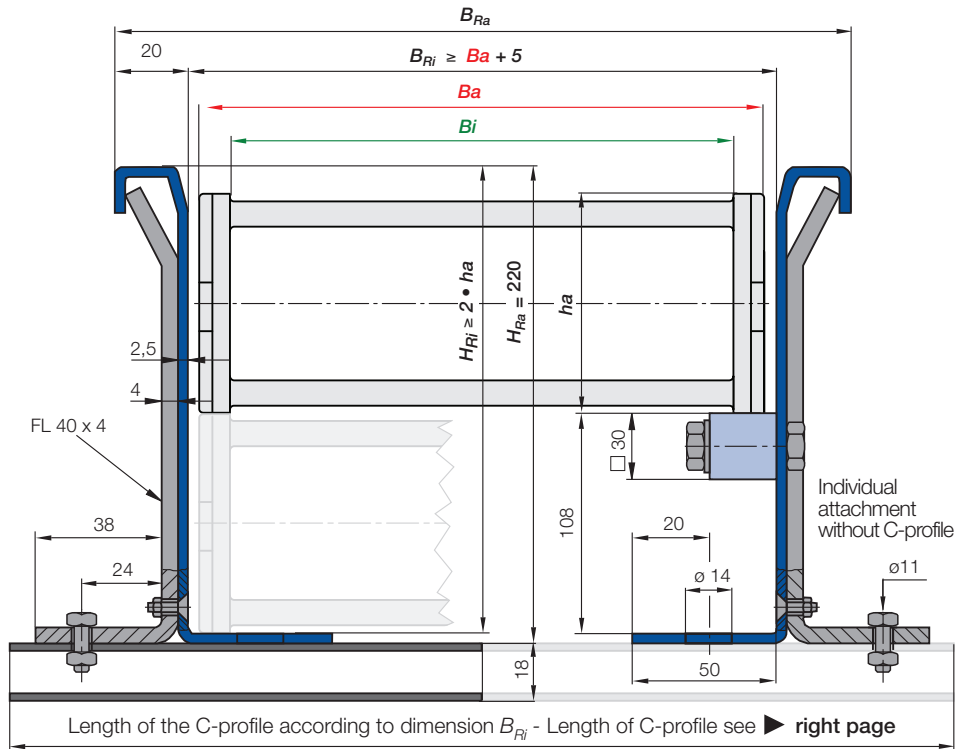

**Steel Guide Trough components - Sets and single parts**

Complete guide trough sets - description	Part No.	Weight	kg
Set of 2 trough side parts <b>without</b> glide bars, 2 m section	96.30	≈ 22,80 kg	
Set of 2 trough side parts <b>with</b> glide bars, 2 m section	96.31	≈ 27,20 kg	
1 Installation set with C-profile	96.50. <input type="text"/>		
1 Installation set without C-profile	96.50	≈ 0,72 kg	
Single parts - description			
1 glide bar, individual, each 2 m	93.01	≈ 1,68 kg	
1 glide bar, individual, each 2 m + 11 screw sets	93.20	≈ 2,22 kg	
11 screw sets for 2 m sections	93.21	≈ 0,54 kg	
1 Clamping bracket, individual	96.51	≈ 0,31 kg	
1 Countersunk-head screw M6 x 14, individual	92.53		
1 Hexagon nut M6, individual	92.54		
1 Hexagon-head screw M10 x 16, individual	92.55		
1 Glide nut M10, individual	92.56		
1 C-profile, individual	92.52. <input type="text"/>	≈ 0,90 kg/m	

Supplement Part No. with the indicated C-profile-length-index. **Example:** 96.50.

C-profile-length-index for your chosen trough inner width  $B_{Ri}$  ► right table

Trough side parts also available in stainless steel. Please add index "E" to the Part No. 96.30.E

**Principle sketch: Number of installation sets which have to be installed**

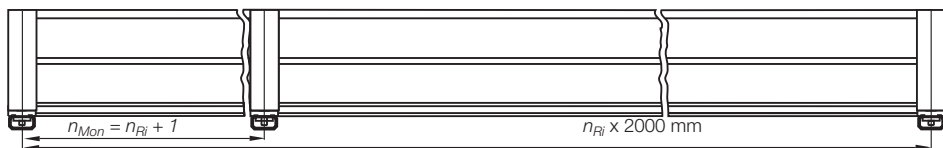

Calculation - travel  
center mounted

Half travel length, rounded down to full 2 m sections = X m guide trough length without glide bars + X m guide trough length with glide bars + installation sets (number of trough pieces + 1)



**Order example: Length of travel 30 m - Center mounted for Series 5050.05.200.0 with  $B_{Ri} = 105$**

Guide trough-set of 2 trough side parts, <b>without</b> glide bars:	
<b>16 m Guide trough = 8 x 2 m sections (without glide bars)</b>	<b>Part No. 96.30</b>
Guide trough-set of 2 trough side parts, <b>with</b> assembled glide bars:	
<b>16 m Guide trough = 8 x 2 m sections (with glide bars)</b>	<b>Part No. 96.31</b>
Installation sets complete (Guide trough-sets + 1)	
<b>17 Installation sets (with C-profile)</b>	<b>Part No. 96.50. <input type="text"/></b>



## Part No. Installation set: Steel Guide Trough with C-profile (in dependance of the width)

E4.80/H4.80/R4.80			5050/5150/R9850			5050HD/R9850HD			15050/15150/R19850			E6.80		
E4.80.10.200.0			5050.10.200.0			5050HD.10.200.0			15050.07.200.0			E6.80.05.200.0		
$B_{Ri}$	Part No.		$B_{Ri}$	Part No.		$B_{Ri}$	Part No.		$B_{Ri}$	Part No.		$B_{Ri}$	Part No.	
[mm]	Installation set		[mm]	Installation set		[mm]	Installation set		[mm]	Installation set		[mm]	Installation set	
.05	105	96.50.225	.05	105	96.50.225	.05	115	96.50.225	.05	85	*	.05	105	96.50.225
.06	120	96.50.250	.06	120	96.50.250	.06	130	96.50.250	.06	100	*	.06	120	96.50.250
.07	130	96.50.250	.07	130	96.50.250	.07	140	96.50.250	.07	110	96.50.225	.07	130	96.50.250
.10	155	96.50.275	.10	155	96.50.275	.10	165	96.50.275	.10	135	96.50.250	.10	155	96.50.275
.11	168	96.50.300	.11	168	96.50.300	.11	177	96.50.300	.11	148	96.50.275	.11	167	96.50.300
.12	180	96.50.300	.12	180	96.50.300	.12	190	96.50.300	.12	160	96.50.275	.12	180	96.50.300
.13	193	96.50.325	.13	193	96.50.325	.13	202	96.50.325	.13	173	96.50.300	.13	192	96.50.325
.15	205	96.50.325	.15	205	96.50.325	.15	215	96.50.325	.15	185	96.50.300	.15	205	96.50.325
.16	218	96.50.350	.16	218	96.50.350	.16	227	96.50.350	.16	198	96.50.325	.16	217	96.50.350
.17	230	96.50.350	.17	230	96.50.350	.17	240	96.50.350	.17	210	96.50.325	.17	230	96.50.350
.18	243	96.50.375	.18	243	96.50.375	.18	252	96.50.375	.18	223	96.50.350	.18	242	96.50.375
.20	255	96.50.375	.20	255	96.50.375	.20	265	96.50.375	.20	235	96.50.350	.20	255	96.50.375
.21	268	96.50.400	.21	268	96.50.400	.21	277	96.50.400	.21	248	96.50.375	.21	267	96.50.400
.22	280	96.50.400	.22	280	96.50.400	.22	290	96.50.400	.22	260	96.50.375	.22	280	96.50.400
.23	293	96.50.425	.23	293	96.50.425	.23	302	96.50.425	.23	273	96.50.400	.23	292	96.50.425
.25	305	96.50.425	.25	305	96.50.425	.25	315	96.50.425	.25	285	96.50.400	.25	305	96.50.425
.26	318	96.50.450	.26	318	96.50.450	.26	327	96.50.450	.26	298	96.50.425	.26	317	96.50.450
.27	330	96.50.450	.27	330	96.50.450	.27	340	96.50.450	.27	310	96.50.425	.27	330	96.50.450
.28	343	96.50.475	.28	343	96.50.475	.28	352	96.50.475	.28	323	96.50.450	.28	342	96.50.475
.30	355	96.50.475	.30	355	96.50.475	.30	365	96.50.475	.30	335	96.50.450	.30	355	96.50.475
.31	368	96.50.500	.31	368	96.50.500	.31	377	96.50.500	.31	348	96.50.475	.31	367	96.50.500
.32	380	96.50.500	.32	380	96.50.500	.32	390	96.50.500	.32	360	96.50.475	.32	380	96.50.500
.33	393	96.50.525	.33	393	96.50.525	.33	402	96.50.525	.33	373	96.50.500	.33	392	96.50.525
.35	405	96.50.525	.35	405	96.50.525	.35	415	96.50.525	.35	385	96.50.500	.35	405	96.50.525
.36	418	96.50.550	.36	418	96.50.550	.36	427	96.50.550	.36	398	96.50.525	.36	417	96.50.550
.37	430	96.50.550	.37	430	96.50.550	.37	440	96.50.550	.37	410	96.50.525	.37	430	96.50.550
.38	443	96.50.575	.38	443	96.50.575	.38	452	96.50.575	.38	423	96.50.550	.38	442	96.50.575
.40	455	96.50.575	.40	455	96.50.575	.40	465	96.50.575	.40	435	96.50.550	.40	455	96.50.575
.41	468	96.50.600	.41	468	96.50.600	.41	477	96.50.600	.41	448	96.50.575	.41	470	96.50.600
.42	480	96.50.600	.42	480	96.50.600	.42	490	96.50.600	.42	460	96.50.575	.42	480	96.50.600
.43	493	96.50.625	.43	493	96.50.625	.43	502	96.50.625	.43	473	96.50.600	.43	492	96.50.625
.45	505	96.50.625	.45	505	96.50.625	.45	515	96.50.625	.45	485	96.50.600	.45	505	96.50.625
.46	518	96.50.650	.46	518	96.50.650	.46	527	96.50.650	.46	498	96.50.625	.46	517	96.50.650
.47	530	96.50.650	.47	530	96.50.650	.47	540	96.50.650	.47	510	96.50.625	.47	530	96.50.650
.48	543	96.50.675	.48	543	96.50.675	.48	552	96.50.675	.48	523	96.50.650	.48	542	96.50.675
.50	555	96.50.675	.50	555	96.50.675	.50	565	96.50.675	.50	535	96.50.650	.50	555	96.50.675
.51	568	96.50.700	.51	568	96.50.700	.51	577	96.50.700	.51	548	96.50.675	.51	567	96.50.700
.52	580	96.50.700	.52	580	96.50.700	.52	590	96.50.700	.52	560	96.50.675	.52	580	96.50.700
.53	593	96.50.725	.53	593	96.50.725	.53	602	96.50.725	.53	573	96.50.700	.53	592	96.50.725
.55	605	96.50.725	.55	605	96.50.725	.55	615	96.50.725	.55	585	96.50.700	.55	605	96.50.725
.60	655	96.50.775	.60	655	96.50.775	.60	665	96.50.775	.60	635	96.50.750	.60	655	96.50.775

\*upon request



Trough (Part No. 96.30 and 96.31)  
with reinforced mounting angles for  
very rugged and extreme applications

! The inner width of the guide through and the length of the C-Profile of the assembly kit can differ according to the bracket you choose. Please call us!





For the following  
E-Chains®/E-Tubes:

System E4 Series

- 600/601/R608
- 640
- 1640/R1608



**Fixed end module**

Quick installation of the mounting brackets due to the prepared bores  
▶ page 9.62

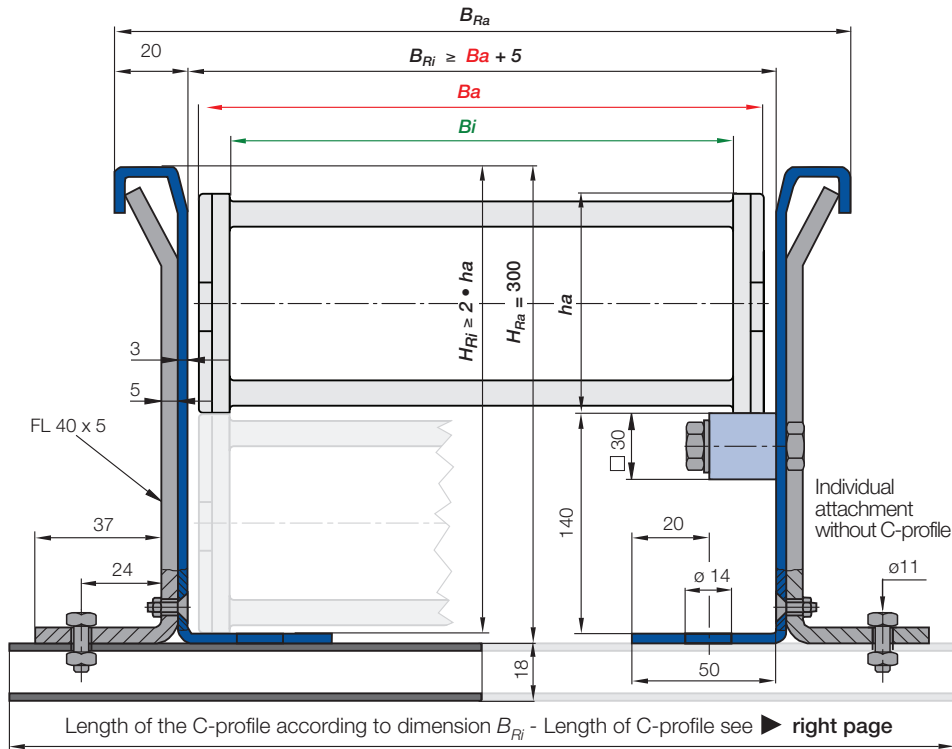

$B_a$  = Outer E-Chain® width

$B_i$  = Inner E-Chain® width

$h_a$  = E-Chain® outer height

$H_{Ri}$  = Inner trough height

$H_{Ra}$  = Outer trough height

$B_{Ri}$  = Inner trough width ▶  
depends on dim.  $B_a$

$B_{Ra}$  = Outer trough width

$n_{Mon}$  = Number of installation  
sets (left/right)

$n_{Ri}$  = Number of trough  
sets (left/right)

**$H_{Ri} \geq 2 \cdot h_a$**

**$B_{Ri} \geq B_a + 5$**

● = Guide trough

● = Glide bar

● = Installation set

● = C-profile

**Steel Guide Trough components - Sets and single parts**

Complete guide trough sets - description	Part No.	Weight	kg
Set of 2 trough side parts <b>without</b> glide bars, 2 m section	98.30	≈ 34,60 kg	
Set of 2 trough side parts <b>with</b> glide bars, 2 m section	98.31	≈ 39,00 kg	
1 Installation set with C-profile	98.50. <input type="text"/>		
1 Installation set without C-profile	98.50	≈ 1,16 kg	
Single parts - description			
1 glide bar, individual, each 2 m	93.01	≈ 1,68 kg	
1 glide bar, individual, each 2 m + 11 screw sets	93.20	≈ 2,22 kg	
11 screw sets for 2 m sections	93.21	≈ 0,54 kg	
1 Clamping bracket, individual	98.51	≈ 0,52 kg	
1 Countersunk-head screw M8 x 20, individual	92.05		
1 Hexagon nut M8, individual	92.04		
1 Hexagon-head screw M10 x 16, individual	92.55		
1 Glide nut M10, individual	92.56		
1 C-profile, individual	92.52. <input type="text"/>	≈ 0,90 kg/m	

Supplement Part No. with the indicated C-profile-length-index. **Example:** 98.50. 375

C-profile-length-index for your chosen trough inner width  $B_{Ri}$  ▶ right table

Trough side parts also available in stainless steel. Please add index "E" to the Part No. 98.30.E

**Principle sketch: Number of installation sets which have to be installed**

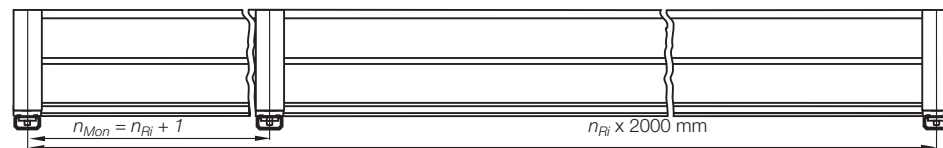

Calculation - travel  
center mounted

Half travel length, rounded down  
to full 2 m sections = X m guide  
trough length without glide bars  
+ X m guide trough length with  
glide bars + installation sets  
(number of trough pieces + 1)



**Order example: Length of travel 30 m -  
Center mounted for Series 600.20.200.0 with  $B_{Ri} = 257$**

Guide trough-set of 2 trough side parts, <b>without</b> glide bars:	
16 m Guide trough = 8 x 2 m sections (without glide bars)	Part No. 98.30
Guide trough-set of 2 trough side parts, <b>with</b> assembled glide bars:	
16 m Guide trough = 8 x 2 m sections (with glide bars)	Part No. 98.31
Installation sets complete (Guide trough-sets + 1)	Part No. 98.50. <input type="text"/> 375
17 Installation sets (with C-profile)	





For the following  
E-Chains®/E-Tubes:

System E4 Series

- 800
- 840

Guide troughs with reinforced brackets for the largest igus® E-Chains® Series 800 and 840. Especially designed for crane and off-shore applications



**Fixed end module**

Quick installation of the mounting brackets due to the prepared bores

▶ page 9.62

$B_a$  = Outer E-Chain® width

$B_i$  = Inner E-Chain® width

$h_a$  = E-Chain® outer height

$H_{Ri}$  = Inner trough height

$H_{Ra}$  = Outer trough height

$B_{Ri}$  = Inner trough width ▶ depends on dim.  $B_a$

$B_{Ra}$  = Outer trough width

$n_{Mon}$  = Number of installation sets (left/right)

$n_{Ri}$  = Number of trough sets (left/right)

**$H_{Ri} \geq 2 \cdot h_a$**   
 **$B_{Ri} \geq B_a + 5$**

● = Guide trough

● = Glide bar

● = Installation set

● = C-profile

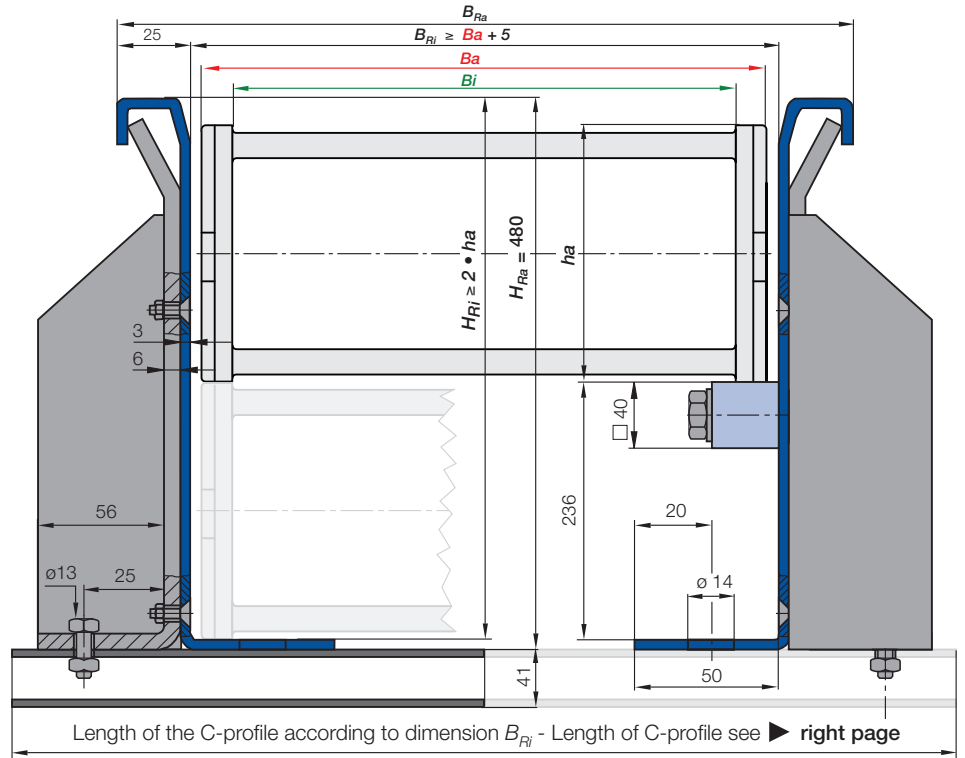

**Steel Guide Trough components - Sets and single parts**

Complete guide trough sets - description	Part No.	Weight	kg
Set of 2 trough side parts <b>without</b> glide bars, 2 m section	90.30	≈ 53,40 kg	
Set of 2 trough side parts <b>with</b> glide bars, 2 m section	90.31	≈ 59,40 kg	
1 Installation set with C-profile	90.50. <input type="text"/>		
1 Installation set without C-profile	90.50	≈ 0,41 kg	
Single parts - description			
1 glide bar, individual, each 2 m	90.01	≈ 3,00 kg	
1 glide bar, individual, each 2 m + 11 screw sets	90.20	≈ 3,50 kg	
11 screw sets for 2 m sections	90.21	≈ 0,50 kg	
1 Clamping bracket, individual	90.51	≈ 2,75 kg	
2 Countersunk-head screws M8 x 25, individual	92.53		
2 Hexagon nuts M8, individual	92.54		
1 Hexagon-head screw M12 x 30, individual	92.55		
1 Glide nut M12, individual	92.56		
1 C-profile, individual	92.52. <input type="text"/>	≈ 0,90 kg/m	

Supplement Part No. with the indicated C-profile-length-index. **Example:** 90.50.

C-profile-length-index for your chosen trough inner width  $B_{Ri}$  ▶ right table

Trough side parts also available in stainless steel. Please add index "E" to the Part No. 90.30.E

**Principle sketch: Number of installation sets which have to be installed**

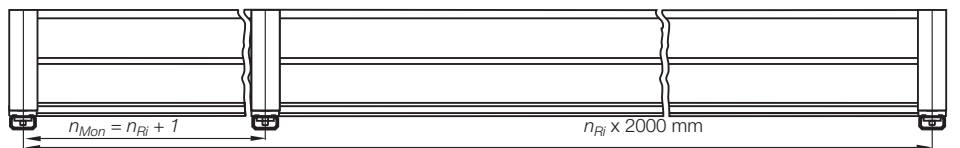

Calculation - travel  
center mounted

Half travel length, rounded down to full 2 m sections = X m guide trough length without glide bars + X m guide trough length with glide bars + installation sets (number of trough pieces + 1)



**Order example: Length of travel 30 m - Center mounted for Series 800.20.325.0 with  $B_{Ri} = 265$**

Guide trough-set of 2 trough side parts, <b>without</b> glide bars:	
<b>16 m Guide trough = 8 x 2 m sections (without glide bars)</b>	<b>Part No. 90.30</b>
Guide trough-set of 2 trough side parts, <b>with</b> assembled glide bars:	
<b>16 m Guide trough = 8 x 2 m sections (with glide bars)</b>	<b>Part No. 90.31</b>
Installation sets complete (Guide trough-sets + 1)	
<b>17 Installation sets (with C-profile)</b>	<b>Part No. 90.50. <input type="text" value="450"/></b>

