

## E2 micro | Series 08

● ● ● Price index



IPA Qualification Certificate:  
Cleanroom test  
upon request



Special equipment:  
Electrically conductive ESD/ATEX  
version upon request



UL94-V2 classifications  
upon request

- ① Small pitch for very quiet operation
  - ② High torsional rigidity
  - ③ Very light weight - low price
  - ④ Dirt-repellent exterior
  - ⑤ Mounting brackets with strain relief options
  - ⑥ One piece each link
  - ⑦ Easy to fill configuration
- **Series E08 Easy Chain®**, page 3.28
- ⑧ Snap-open configuration
  - **Series 09 Zipper**, page 4.14
  - **Series B09 E2 micro**, page 5.38
  - ⑨ Fully enclosed E-Tube
  - **Series R09 Zipper Tube**, page 4.32



Easy to assemble and to disassemble



When to use the Series 08:

- If quiet operation is required
- If price is an issue
- If connection options are required (Quicksnap, Quickfix, ...)
- If high torsional rigidity is required



When not to use it:

- If snap-open links are required
  - **Series 09 Zipper**, page 4.14
  - **Series B09 E2 micro**, page 5.38
- If quick insertion of cables with preassembled connectors is required
  - **Series E08 Easy Chain®**, page 3.28



Order example complete E-Chain®

Please indicate chain-lengths or number of links **Example: 1 m or 50 links**

1 m **08.30.038.0**



**E-Chain®**

1 set **080.30.12PZ**



**Mounting bracket**



### Unsupported length

$FL_G$  = with straight upper run  
 $FL_B$  = with permitted sag  
 Further information ► Design, page 1.12

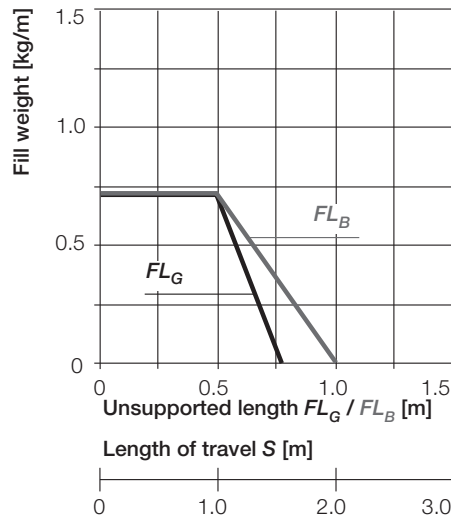
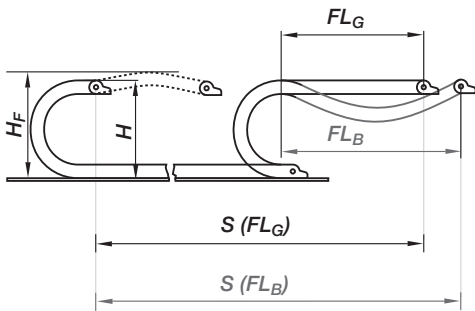

- $S$  = Length of travel
- $R$  = Bending radius
- $H$  = Nominal clearance height
- $H_F$  = Required clearance height
- $D$  = Overlength E-Chain® radius in final position
- $K = \pi \cdot R + \text{"safety"}$

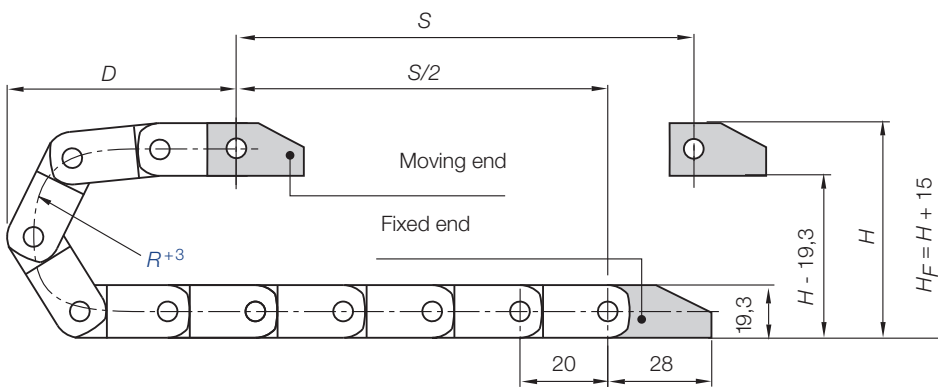

### Short travels - unsupported

Unsupported E-Chains® feature positive camber over short travels. This must be accounted for when specifying the clearance height  $H_F$ . Please consult igus® if space is particularly restricted.

Pitch = 20 mm/link    Links/m = 50 (1.000 mm)    Chain length =  $S/2 + K$

R	025*	028	038	048
H	70	76	96	116
D	57	60	70	80
K	120	130	160	190

\*Radius 025 only for Part No. 08.10

The required clearance height:  
 $H_F = H + 15 \text{ mm}$   
 (with 0,3 kg/m fill weight)



E2 micro  
 Inner height: 15 mm

Phone +49- (0) 22 03-96 49-800  
 Fax +49- (0) 22 03-96 49-222



Speed / acceleration $FL_G$	max. 20 [m/s] / max. 200 [m/s <sup>2</sup> ]
Speed / acceleration $FL_B$	max. 3 [m/s] / max. 6 [m/s <sup>2</sup> ]
Gliding speed / acceleration (maximum)	max. 3 [m/s] / max. 10 [m/s <sup>2</sup> ]
Material - permitted temperature °C	igumid G / -40° up to +120° C
Flammability class, igumid G	VDE 0304 IIC UL94 HB

### Technical Data



Details of material properties  
 ► page 1.38

► page 5.9

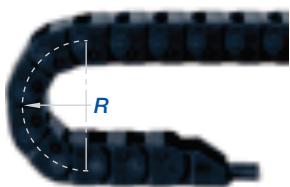
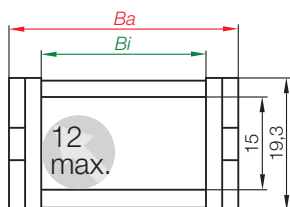

## Series 08 E-Chain® - non snap-open

Part No.	$B_i$ [mm]	$B_a$ [mm]	$R$ [mm]	Bending radii	Weight [kg/m]
08.10.□.0	10	18,2	025 028 038 048		≈ 0,21
08.13.□.0	13	21,2	028 038		≈ 0,23
08.16.□.0	16	24,2	028 038 048		≈ 0,24
08.20.□.0	20	28,2	028 038 048		≈ 0,25
08.30.□.0	30	38,2	028 038 048		≈ 0,28
08.40.□.0	40	48,2	028 038 048		≈ 0,31
08.50.□.0	50	58,2	028 038 048		≈ 0,37

Supplement Part No. with required radius. Example: 08.30.038.0

0 = standard color, other colors ► page 1.39 · Pitch = 20 mm/link - Links/m = 50

## Part No. structure

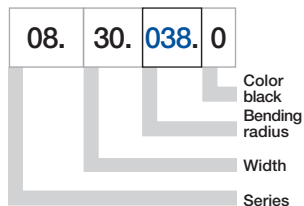

Tel. +49- (0) 22 03-96 49-800  
Fax +49- (0) 22 03-96 49-222

igus® GmbH  
51147 Cologne

Internet: [www.igus.eu](http://www.igus.eu)  
E-mail: [info@igus.de](mailto:info@igus.de)



**Polymer, one-piece**

- One-piece mounting bracket
- Corrosion-resistant
- Available preassembled
- Inner and outer attachment possible
- Available with or without strain relief tiwrap plates

Moving end with bore  
(outer link) 080...1 (PZ)

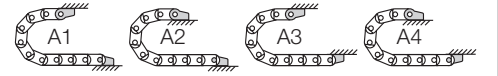
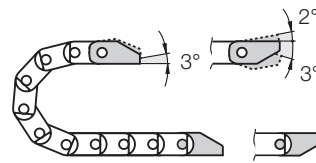

080...2 (PZ) Fixed end  
with pin (inner link)

Possible installation conditions for assembled mounting brackets ▶ Order example "preassembled" below

080...1 (PZ)

Moving end

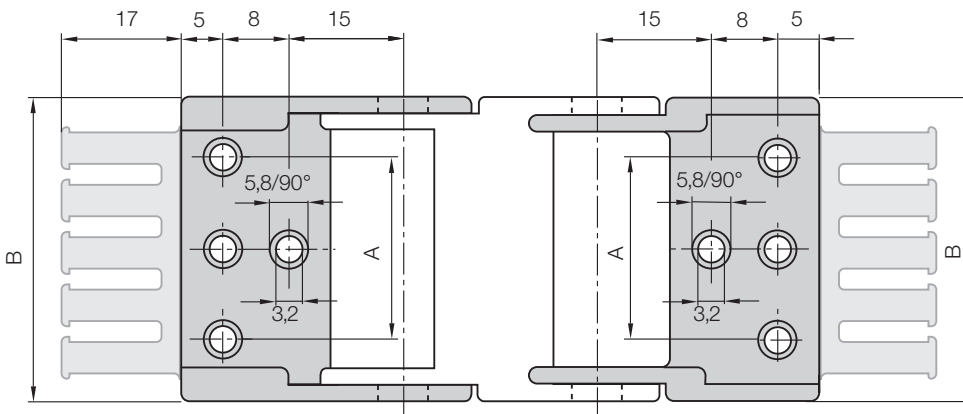

080...2 (PZ)

Fixed end

**Dimensions and order configurations**

Strain relief is possible on the moving end and/or the fixed end.

080.06.12 - 080.20.12: center bores only

080.30.12 - 080.50.12: all bores

For E-Chain®	Part No. full set with tiwrap plate	Part No. full set without tiwrap plate	Number of teeth	Dim. A [mm]	Dim. B [mm]
08.10. ▶	080.10. 12 PZ	080.10. 12	1	-	18,2
08.13. ▶	080.16. 12 PZ	080.13. 12	-	-	21,2
08.16. ▶	080.16. 12 PZ	080.16. 12	2	-	24,2
08.20. ▶	080.20. 12 PZ	080.20. 12	2	-	28,2
08.30. ▶	080.30. 12 PZ	080.30. 12	3	22	38,2
08.40. ▶	080.40. 12 PZ	080.40. 12	4	32	48,2
08.50. ▶	080.50. 12 PZ	080.50. 12	5	42	58,2

For the preassembled mode please add the index A1 ... A4 e.g. 080.30. 12 PZ A1

**Part No. structure**

080.30.12.PZ.A1

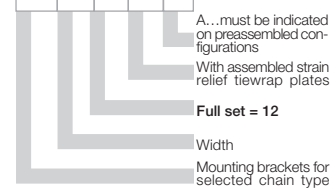

Full set, for both ends:

080.30.12.PZ +tiwrap plate

Single-part order:

080.30.1.PZ +tiwrap plate

Mounting bracket with bore

080.30.2.PZ +tiwrap plate

Mounting bracket with pin



**Quicksnap** - the complete, detachable mounting unit, upon request

Part No. 080.20.QS, Part No.080.30.QS



**Quickfix** - mounting bracket with dowel, upon request

**Additional Features**

Phone +49- (0) 22 03-96 49-800  
Fax +49- (0) 22 03-96 49-222

